



# Vectron Systems AG – Data sheet

## Vectron POS Modular

November 2007

### Technical data – Hardware

- High-quality metal housing, brushed and sand-blasted aluminium
- VGA-port for external monitor with 800 x 600 pixels (SVGA) and 256 colours; expandable to 1024 x 768 pixels (XGA)
- Standard lock ‚Dallas iButton‘, also in magnetic design, optionally with ‚Addimat‘ lock
- Optional touch screen operation
- 10/100BaseT Ethernet port for network operation
- Six serial ports for printers, scanners, card terminals, customer displays, dispensing systems etc.
- One parallel port
- Two USB ports (Host & Function)
- Two ports for up to four cash drawers (per adapter) with ‚Open Sensor‘
- One PS/2 port for PC-keyboard and PC-mouse
- Optional two ports for external clerk locks ‚Dallas iButton‘ Magnet or ‚Addimat‘
- 8 MB FlashROM for system software
- 2 MB RAM (battery-buffered), extendable to 4, 6 or 10 MB
- LED integrated in housing, for optical perception of network operation or warnings
- Standard graphics card for connection of a monitor, standard resolution 800 x 600 pixels (SVGA)
- Operable via external keyboard or touch screen (only with respective license and hardware)
- 0 ... 40°C operation temperature
- -10 ... +50°C storage temperature



Vectron POS Modular with „Addimat“ lock



Vectron POS Modular with Monitor Vectron D151T

Certified: CE



# Vectron

Leading in POS Technology



# Vectron Systems AG – Data sheet Vectron POS Modular

November 2007

## Technical data – Software

- 100,000 PLUs\*
- 65,535 departments\*
- 1,000 clerks\*
- 65,535 guest checks or customers\*
- 200 cash registers per network\*
- 100 printers per network\*

\*) The indicated values are maximum values, which can only be reached with special programming and optimum hardware equipment. Please contact your Vectron dealer to assist you with your special requirements.

## Weight

- approx. 2480 g

## Optional accessories

- Monitor Vectron D80T
- Monitor Vectron D151T
- Monitor Vectron D153T
- External clerk locks ‚Dallas iButton Magnet‘ and ‚Addimat‘
- Internal lock systems
- RAM-memory expansion 2, 4, 8 MB

## Shipment

Standard shipment of the Vectron POS Modular comprises:

- Vectron POS Modular, equipment as per order
- External power supply Vectron PS10
- National mains plug
- Clerk lock as per order
- User manual
- Dispatch box
- Software license as per order

## Dimensions

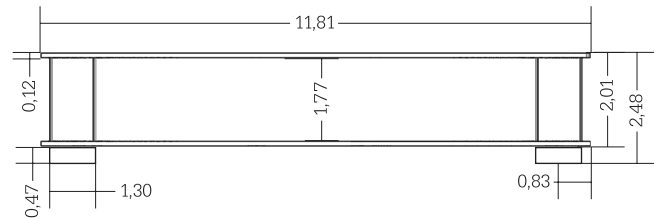

Front view - dimensions in inch\*

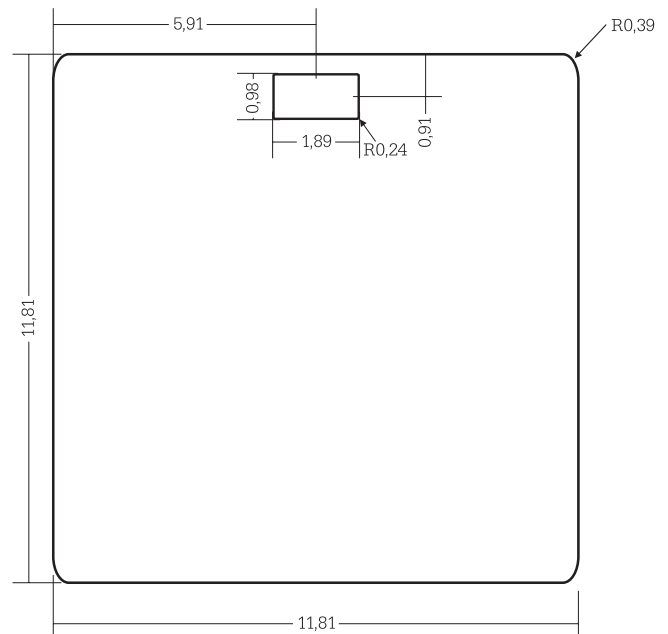

View from top - dimensions in inch\*

\* 1 inch = 25,4 mm



# Vectron

Leading in POS Technology